

Telescoping Flagpole Installation Instructions

Patent #5, 540, 017

CAUTION: Failure to follow these instructions can result in **PERSONAL INJURY!** Please read these instructions in its' entirety before attempting to complete this process.

What You Will Need

- Telescoping Flagpole
- Sleeve that came with the Telescoping Flagpole
- 3 bags of pre-mixed concrete (40 lbs each)
- Measuring stick
- Level
- Small rock or coarse gravel
- Something to mix the concrete or cement

**For Technical Assistance call
SunSetter Products
1-800-670-7071**

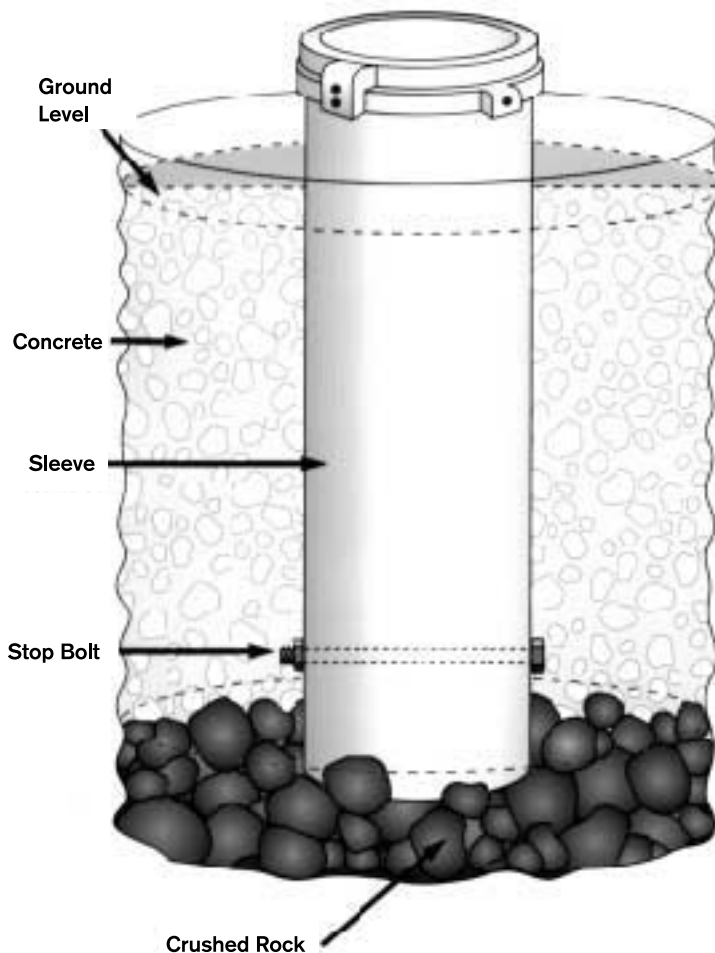

1. Make sure you have all items listed.
2. Dig a hole approximately 12" in diameter and 22" deep in hard soil conditions. A larger hole may be required in light soil.
3. Place a bed of gravel or small rock in the hole.
4. Install the stop bolt and nut through the sleeve as shown. This is important since the bolt will keep the flagpole up off the bottom.
5. Place the sleeve in the hole with stop bolt facing down.
6. Place small rock or gravel in and around the sleeve to a height of 2" from the bottom of sleeve. This will help with drainage.
7. Mix the concrete or cement.
8. Pour the concrete or cement around the sleeve, being careful not to get concrete or cement inside the sleeve. Fill the hole approximately 1" from ground level with the concrete or cement.
9. Place the flagpole in the sleeve and level the flagpole from two sides. When the sleeve is level, carefully remove the flagpole, making sure you do not disturb the position of the sleeve.
10. Let the concrete or cement harden for at least 24 hours. We strongly suggest placing some warning or object near the hole to prevent people from moving the sleeve or tripping in the hole.
11. After at least 24 hours place dirt or other landscape material around the sleeve to create a finished look and prevent accidents. The plastic cap that comes with your flagpole should be used to plug the sleeve when the flagpole is removed from the sleeve.

(Instructions for use on reverse side...)

Rev 12/01/04

How to Use Your Flagpole



To Raise the Pole

Pull each section up slowly until automatically locked, starting from the top inner section.

To Lower the Pole

CAUTION: Hold on to the section to be lowered. Press the locking button (see Figure 1) to release, and allow the section to slide down slowly through your hands.

To Secure each Section in the Extended Position with the Optional Childproof Lock

1. A small bag that contains the "childproof" Allen screw locks for the section bushings and ground sleeve collar, as well as a 5/64" Allen wrench is included with each flagpole. Install one short "childproof" Allen screw lock in the threaded hole of each top bushing of every pole section.
2. Using the Allen wrench supplied, turn the screw lock 3 complete turns to secure the desired position. Do NOT overturn. (See Figure 1).

CAUTION: Before releasing the push button to lower each section, unlock the Allen screw so the head of the screw is flush with the outside edge of the bushing. Failure to do so could result in the pole being scratched.

Prior to Using the Optional Locking Ground Sleeve Feature

1. Insert the pole into ground sleeve.
2. Install one long "childproof" Allen screw lock in the threaded hole of the ground sleeve collar.
3. Tighten the Allen screw lock against the pole to make a mark (See Figure 2).
4. Loosen the Allen screw lock and remove the pole from the sleeve.
5. CAUTION: Extend the second section from the bottom at least 2 feet to prevent drilling through both poles.
6. Center punch at the mark left by the screw lock, and using a 3/16" drill bit, drill a hole through one wall of the outer section.

To Secure the Pole to the Ground Sleeve

1. Align the drilled hole in the pole with the Allen locking screw lock in the locking collar.
2. Using the Allen wrench supplied, turn the screw lock 4 complete turns to secure the collar to the pole. Do NOT overturn. (See Figure 2).

Caution - Do Not Use Any Silicone Lubricants

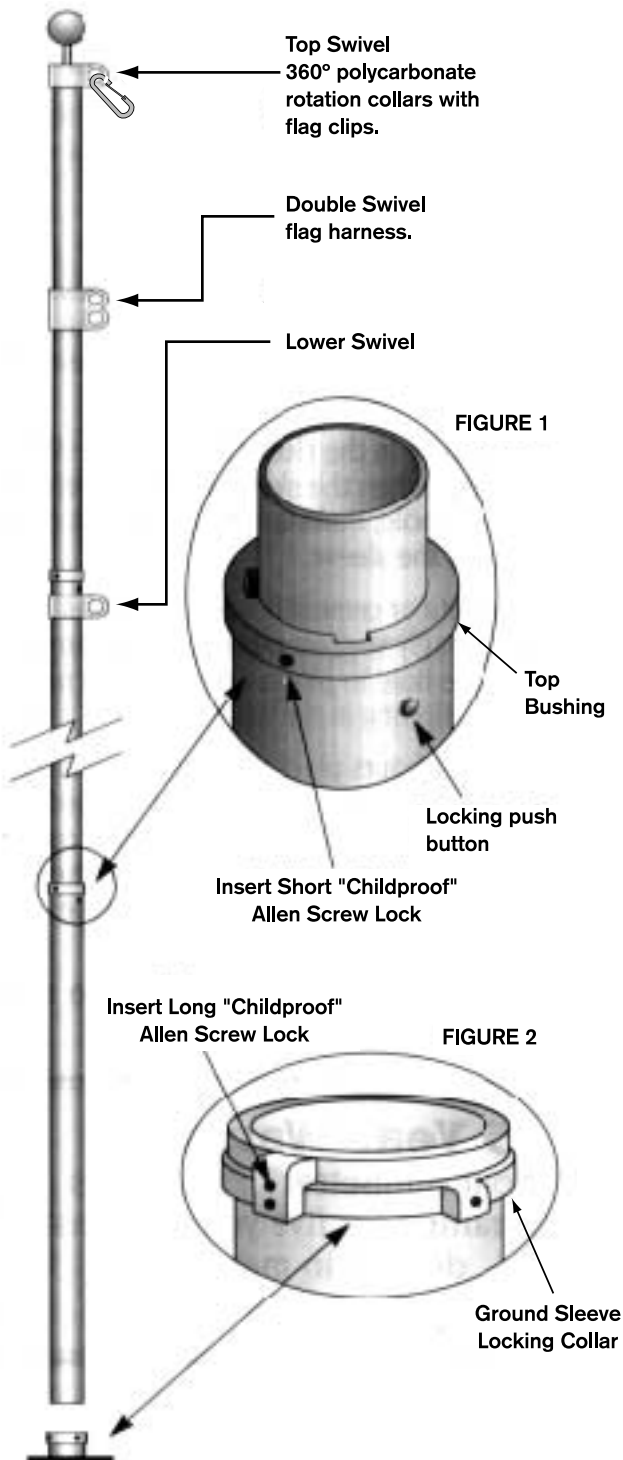

Plastic Storage Cap
16'-FP3013
20'-FP3012

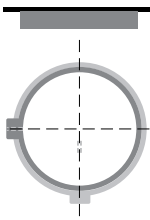

Groundsleeve Complete
16'-FP033-1
20'-FP025-1

Stainless Clip
FP3011-1S
Qty 4

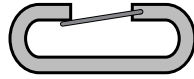

Universal Wheelstand
FP9040
(optional)

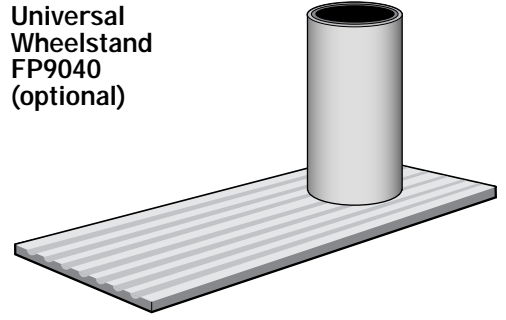

Locking Collar
16'-FP034-1
20'-FP026-1

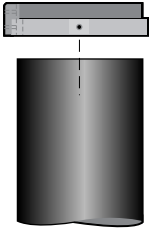

5/64"
Allen
Wrench

Stop Nut & Bolt
FP3000-1

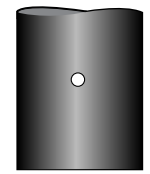

Horizontal Deck/Dock mount
FP9054
(optional)

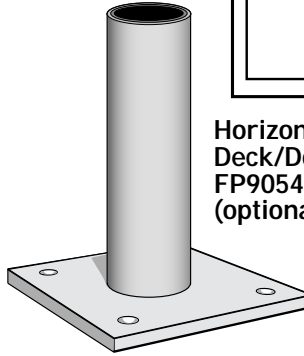

Vertical Deck/Dock Mount
FP9045
(optional)

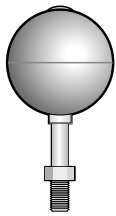
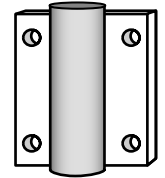

Gold Ball-
FP1011

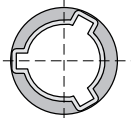

Top Bushing
FP022-1

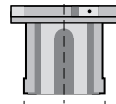

Lower Swivel
FP013-1

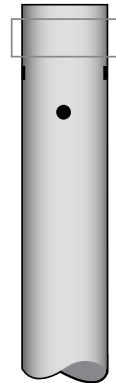

Spring Button
FP019-1

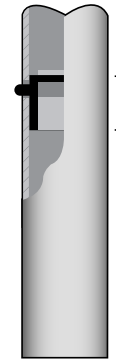

Bottom Cap
FP014-1

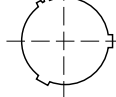

Complete
Tube #2, FP007-1
16' and 20'

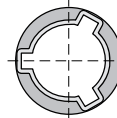

Top Bushing
FP021-1

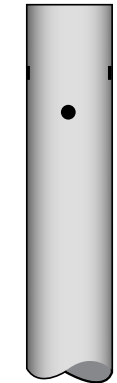
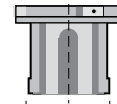

Spring Button
FP020-1

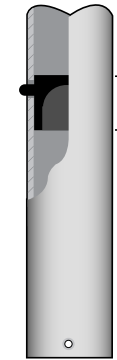

Bottom Cap
FP015-1

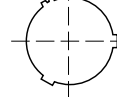

Complete
Tube #3, FP008-1
20' Only

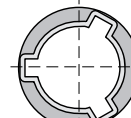

16' Top Bushing
FP021-1
20' Top Bushing
FP023-1

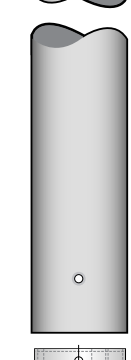
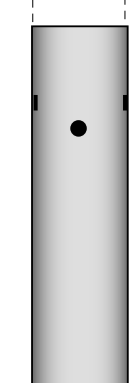
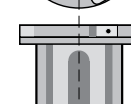

End Cap
16'-FP032-1
20'-FP016-1

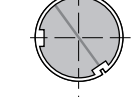

Complete Bottom Section
Tube #3, 16' Only-FP008-2
Tube #4, 20' Only-FP009-1



Top Cap
FP011-1

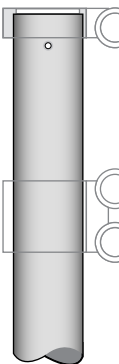

Top Swivel
FP010-1

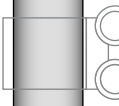

Double Swivel
FP012-1

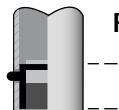

Spring Button
FP018-1

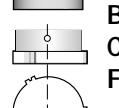

Bottom Cap
FP017-1

Complete Top Section
Tube #1, FP006-1
16' and 20'

Parts List

Part #	Description
FP006-1	Tube #1 (top) Complete Anodize
FP007-1	Tube #2 Complete Anodized
FP008-1	Tube #3 (for 20') Complete Anodized
FP008-2	Tube #3 (largest on 16') Complete Anodized
FP009-1	Tube #4 (largest on 20') Complete Anodized
FP010-1	Top swivel (w/out clips)
FP011-1	Tube #1 Top Cap
FP012-1	Double Swivel (w/out clips)
FP013-1	Lower Swivel (w/out clips)
FP014-1	Tube #2 Bottom Cap
FP015-1	Tube #3 Bottom Cap
FP016-1	Tube #4 Base Cap w/foam bumper (for 20' only)
FP017-1	Tube #1 Bottom Cap
FP018-1	Tube #1 Spring Button
FP019-1	Tube #2 Spring Button w/foam bumper
FP020-1	Tube #3 Spring Button w/foam bumper
FP021-1	Tube #3 Clear Top Bushing w/set screw
FP022-1	Tube #2 Clear Top Bushing w/set screw

Part #	Description
FP023-1	Tube #4 Clear Top Bushing w/set screw
FP025-1	Ground sleeve for 20' pole-Complete/ w/collar
FP026-1	Locking Collar w/set screw for 20' ground sleeve
FP032-1	Tube #3 Base Cap w/foam bumper (for 16' only)
FP033-1	Ground sleeve for 16' pole-Complete w/collar
FP034-1	Locking Collar w/set screw for 16' ground sleeve
FP1011	Gold Ball (3")
FP1012	Nylon US Flag (3 x 5)
FP1600-1	Hardware Kit for 16' flagpole
FP2000-1	Hardware Kit for 20' flagpole
FP3000-1	Ground sleeve stop bolt w/nut
FP3010-1	Allen wrench 5/64"
FP3011-1S	Flag Clips (4) for swivels (stainless)
FP3012	Plastic storage cap for 20' flagpole
FP3013	Plastic storage cap for 16' flagpole
FP9040	Wheelstand- 20'
FP9045	Vertical Deck/ Dock Mount- 20'
FP9054	Horizontal Deck/ Dock Mount- 20'

TROUBLESHOOTING

IF.....	THEN.....
The spring button will not pop out.....	The button needs to be replaced.
The top swivel does not swivel.....	Check to see that the mounting screw for the top cap is not too tight, binding the top swivel.
The double swivel does not swivel.....	Check to see that the small tab between the two loops of the double swivel is not missing. If the loops are not held apart by this tab, the swivel will need to be replaced.
The lower swivel does not swivel.....	Check to see that the small tab between the two loops of the lower swivel is not missing. If the loops are not held apart by this tab, the swivel will need to be replaced.
You would like to fly a larger flag.....	Attach either one 4x6 or one 5x7 flag to the pole.